

The new generation of NiTi Files

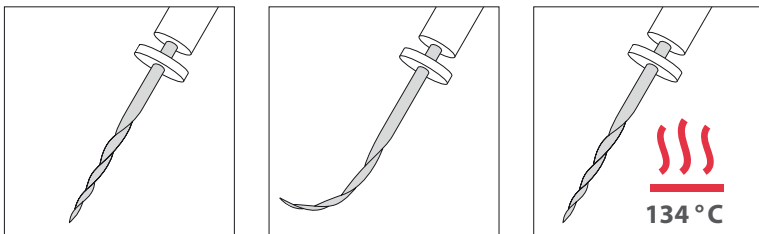

Like a Phoenix from the ashes...
...the regenerative NiTi File!

HyFlex™CM



- No shape memory + Extreme flexibility = Superior canal tracking
- Regains shape after heat treatment = Multi-use
- Up to 300% more resistance to separation

COLTENE®ENDO

No shape memory
+ Extreme flexibility
= Superior canal tracking

HyFlex™ Controlled Memory NiTi Files have been manufactured utilizing a unique process that controls the material's memory, making the files extremely flexible but without the shape memory of conventional NiTi Files. This gives the file the ability to follow the anatomy of the canal very closely, reducing the risk of ledging, transportation or perforation. Furthermore the files can be pre-bent, similar to the way of stainless steel. Particularly in root canals with abrupt curvatures this can help to avoid the creation of steps.

Controlled Memory

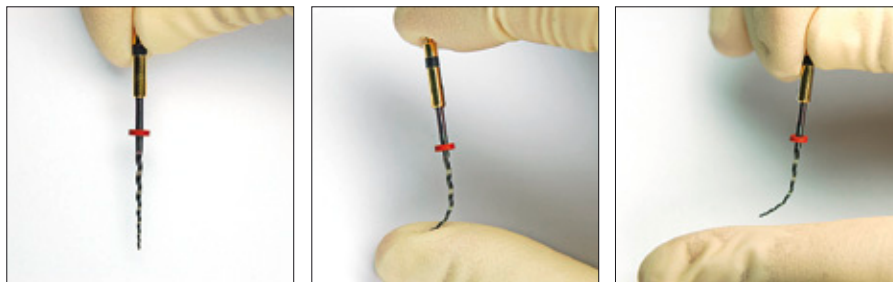

Regains shape after heat treatment
= Multi-use



HyFlex™ CM NiTi Files respond to excessive resistance with straightening of the spirals, which avoids binding to the walls and therefore increases fracture resistance. This form adaptation can be reversed quickly by heat treatment (during autoclaving or with a glass bead sterilizer) returning the instruments back to their original shape. Furthermore it will strengthen the files making them a lot more resistant to cyclical fatigue. Also it provides a clear visual opportunity to verify safe continuation of file use.

Up to 300% more resistance to separation

Cyclic Fatigue Test *

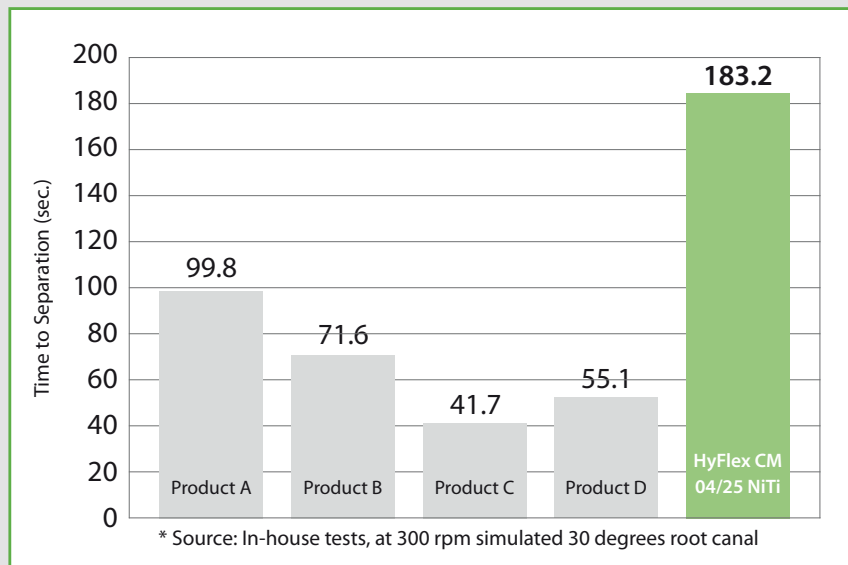

HyFlex™ CM NiTi Files with Controlled Memory are up to 300% more resistant to cyclical fatigue compared to conventional NiTi Files which substantially helps reducing the incidence of file separation.

STEP BY STEP -

HyFlex™ CM NiTi Files can be used with crown-down, step-back or our recommended single length technique:

Use your technique or try ours

Use a Slow Speed Handpiece at 500 rpm.
Recommended Torque Setting up to 2.5 N·cm (25 mN·m)

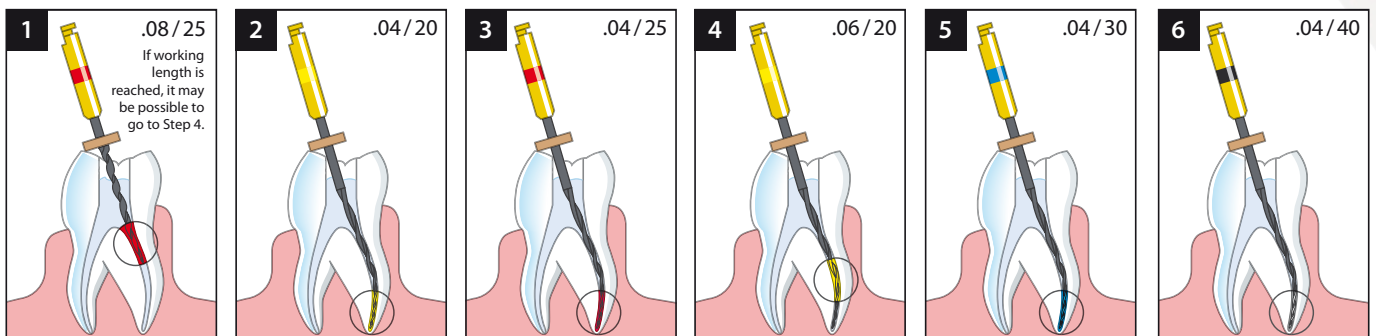

Matching Guttapercha points

COLTENE ENDO offers matching ROEKO Guttapercha points in assortments or single sizes in 0.04 and 0.06 tapers. This makes obturation with warm, cold condensation techniques or the GuttaFlow® system very precise and easy.



Clinical Cases



Pre-op



Post-op

Proximal Crack tooth # 16, Instrumented with HyFlex™, canals filled with GuttaFlow®.

Pictures: Prof. Dr. Ricardo Caicedo,
University of Louisville, USA



Pre-op



Post-op

Pictures: Dr. Nicola M. Grande,
University „La Sapienza“, Rome, Italy

CanalPro CL – Cordless Handpiece



- Thin ergonomic design for better access to hard to reach areas
- Large, user-friendly LCD panel
- Memory for up to 5 programs
- Auto-reverse modus
- 6 head positions allows of contra angle head to be adjusted to your preferred position
- Operates continuously for approx. 80 minutes at rated load
- Quick charging time of approx. 90 minutes – non-contact charger prevents improper charging due to deterioration of metallic terminal
- Energy-saving, turns off when not used for 10 minutes
- Contra angle head is autoclavable at 135°C
- Rotation Speed (min⁻¹): 140 ~ 550
- Torque Level (N·cm): 0,3 ~ 3,0

HyFlex™ CM NiTi Files & Accessories

REF	Description/Contents (Taper/Size)	Length	Amount
6001 1048	HyFlex™ CM NiTi File Refill 08/25	19 mm	6 files/pack
6001 1049	HyFlex™ CM NiTi File Refill 04/15	21 mm	6 files/pack
6001 1050	HyFlex™ CM NiTi File Refill 04/20	21 mm	6 files/pack
6001 1052	HyFlex™ CM NiTi File Refill 04/25	21 mm	6 files/pack
6001 1053	HyFlex™ CM NiTi File Refill 04/30	21 mm	6 files/pack
6001 1054	HyFlex™ CM NiTi File Refill 04/35	21 mm	6 files/pack
6001 1055	HyFlex™ CM NiTi File Refill 04/40	21 mm	6 files/pack
6001 1056	HyFlex™ CM NiTi File Refill 04/45	21 mm	6 files/pack
6001 1057	HyFlex™ CM NiTi File Refill 04/50	21 mm	6 files/pack
6001 1058	HyFlex™ CM NiTi File Refill 04/60	21 mm	6 files/pack
6001 1059	HyFlex™ CM NiTi File Refill 06/20	21 mm	6 files/pack
6001 1060	HyFlex™ CM NiTi File Refill 06/25	21 mm	6 files/pack
6001 1061	HyFlex™ CM NiTi File Refill 06/30	21 mm	6 files/pack
6001 1062	HyFlex™ CM NiTi File Refill 06/35	21 mm	6 files/pack
6001 1063	HyFlex™ CM NiTi File Refill 06/40	21 mm	6 files/pack
6001 1064	HyFlex™ CM NiTi File Refill Sequence, 21 mm (04/20 21 mm; 04/25 21 mm; 04/30 21 mm; 04/40 21 mm; 06/20 21 mm; 08/25 19 mm)		1 file each/pack
6001 1065	HyFlex™ CM NiTi File Refill 04/15	25 mm	6 files/pack
6001 1066	HyFlex™ CM NiTi File Refill 04/20	25 mm	6 files/pack
6001 1067	HyFlex™ CM NiTi File Refill 04/25	25 mm	6 files/pack
6001 1068	HyFlex™ CM NiTi File Refill 04/30	25 mm	6 files/pack
6001 1069	HyFlex™ CM NiTi File Refill 04/35	25 mm	6 files/pack
6001 1070	HyFlex™ CM NiTi File Refill 04/40	25 mm	6 files/pack
6001 1071	HyFlex™ CM NiTi File Refill 04/45	25 mm	6 files/pack
6001 1072	HyFlex™ CM NiTi File Refill 04/50	25 mm	6 files/pack
6001 1073	HyFlex™ CM NiTi File Refill 04/60	25 mm	6 files/pack
6001 1074	HyFlex™ CM NiTi File Refill 06/20	25 mm	6 files/pack
6001 1075	HyFlex™ CM NiTi File Refill 06/25	25 mm	6 files/pack
6001 1076	HyFlex™ CM NiTi File Refill 06/30	25 mm	6 files/pack
6001 1077	HyFlex™ CM NiTi File Refill 06/35	25 mm	6 files/pack
6001 1078	HyFlex™ CM NiTi File Refill 06/40	25 mm	6 files/pack
6001 1079	HyFlex™ CM NiTi File Refill Sequence, 25 mm (04/20 25 mm; 04/25 25 mm; 04/30 25 mm; 04/40 25 mm; 06/20 25 mm; 08/25 19 mm)		1 file each/pack
6001 1080	HyFlex™ CM Introkit Procedure Block HyFlex™ CM NiTi File Sequence, 21 mm HyFlex™ CM NiTi File Sequence, 25 mm ROEKO Greater Taper 0.04 20-45 HyFlex™ CM Endo Procedure Block HyFlex™ CM Endo Practice Block Pack		2 packs 4 packs 60 points 1 pc. 3 acrylic blocks
6001 1083	HyFlex™ CM Endo Procedure Block		1 pc.
6001 1085	HyFlex™ CM Endo Practice Block Pack		3 acrylic blocks

CanalPro CL Cordless Handpiece & Accessories

REF	Description/Contents	Amount
6001 1035	CanalPro CL Complete Set EU CanalPro CL Motor Handpiece CanalPro CL Contra Angle 16:1 CanalPro CL Charger	1 pc. 1 pc. 1 pc.
6001 1036	CanalPro CL Complete Set UK CanalPro CL Motor Handpiece CanalPro CL Contra Angle 16:1 CanalPro CL Charger	1 pc. 1 pc. 1 pc.
6001 1037	CanalPro CL Motor Handpiece	1 pc.
6001 1038	CanalPro CL Charger	1 pc.
6001 1039	CanalPro CL Contra Angle 16:1	1 pc.



Coltene/Whaledent

GmbH + Co. KG

Raiffeisenstraße 30
89129 Langenau/Germany
Tel. +49 (0)7345 805 0
Fax +49 (0)7345 805 201
info@coltenewhaledent.de

Coltene/Whaledent AG

Feldwiesenstraße 20
9450 Altstätten/Switzerland
Tel. +41 (0)71 757 53 00
Fax +41 (0)71 757 53 01
info@coltenewhaledent.ch

Coltene/Whaledent Ltd.

The President Suite-A
Kendal House, Burgess Hill
Victoria Way
West Sussex, RH15 9NF/U.K.
Tel. +44 (0)1444 235486
Fax +44 (0)1444 870640
info@coltenewhaledent.co.uk

www.coltenewhaledent.com

COLTENE® ENDO